

# INSTALLATION AND MAINTENANCE INSTRUCTIONS

## RECYCLED LEATHER SERIES

### GENERAL INFORMATION

All floors in the Recycled Leather Series are HDF constructed and can be installed quickly and easily thanks to the patented UNICLIC® system. The elements are profiled to fit precisely all around and are basically mechanically locked together and thus connected without glue by the click connection. Convincing properties such as extremely robust, non-slip, dirt-repellent and antistatic characterize this floor. Karta flooring is the optimal renovation floor. If necessary, chipboard or wooden floors must be sanded. All floors must be vibration-free and will be re-screwed if necessary.

NOTE: Karta HDF floor is not suitable for wet rooms!

### SUBFLOOR PREPARATION

Karta HDF flooring is laid as a floating floor. The substrate must be clean, permanently dry, level and resistant to tension and compression in accordance with DIN 18365 „Floor covering work“. Small, protruding unevenness, such as paint drops, plaster residues, etc. must be removed. The evenness of the substrate must comply with the specifications of DIN 18202 „Evenness tolerances“ Table 3 / Line 4. The maximum height tolerance of 3 mm per meter must not be exceeded. Unevenness must be levelled with suitable filling compounds. Installation on carpeting of any kind is not possible.

NOTE: Full-surface gluing to the substrate is not approved!

Before installation, a moisture measurement of the substrate must be done and protocolled.

The permissible screed moisture contents according to the CM method:

#### **Cement-based screeds:**

General < 2.0 % CM / heating screed < 1.8 % CM.

#### **Calcium sulfate based screeds:**

**General** < 0.5 % CM / Heating screed < 0.3 % CM.

At the time of installation and afterwards, the surface temperature of the substrate must be at least 15 °C.

### Storage and tempering

Before installation, store the closed Karta packages lying flat for at least 24 hours

in the installation room at 15 - 25 °C and a relative humidity of 40 - 60 % for acclimatization.

### Check

The planks must be carefully checked in daylight for transport damage and any material defects before installation. Planks with minor damage can be processed in places where cutting is required anyway. Slight differences in color and structure are due to the material, enhance the natural character and are therefore no reason for complaint. Make sure that the subfloor and building conditions meet the requirements of these instructions. If the material or the building conditions do not meet the requirements, do not start the installation

NOTE: There is no claim for replacement of processed material - processed goods are accepted goods!

### PE foil / sliding layer / moisture barrier

A moisture barrier with an Sd value  $\geq 100$  m (e.g. 0.2 mm PE film - follow manufacturer's instructions!) must be laid on all mineral substrates. This should overlap by approx. 20 cm and must be taped at the joints. The film should be pulled up approx. 2 - 3 cm on the walls.

TIP: In general, it is recommended to use PE foil on any type of subfloor to promote floating of the floor - on a sliding layer.

### Isolation mat

Karta prefabricated flooring is already delivered with a laminated impact sound isolation made of cork or Green Sound - no further impact sound isolation is required.

TIP: Should you nevertheless decide to make an additional improvement, the chosen isolation mat must meet a minimum CS value requirement ( pressure resistance at defined compression strength) of  $\geq 200$  kPa (ask for the manufacturer's technical data sheet).

### Maximum room size

The maximum allowable area without additional expansion joints is 15 m x 12 m.

### Joints

Expansion joints defined by the building site in the substrate (e.g. abutting screed of different rooms) must be adopted congruently.

During installation, a distance of at least 10 mm to the wall and also to other building components must be maintained (in larger rooms at least 1 mm per meter of room width).

Usually, edge joints are covered with a suitable skirting board and expansion joints with transition profiles. Edge and expansion joints must never be filled completely with silicone or similar.

### INSTALLATION

Open the package only at installation and mix planks from different packages to get an even installation pattern.

TIP: Laying should be done lengthwise to the incidence of light. Discuss the possibilities with the contractor. NOTE: Karta HDF Floor is not suitable as a self-supporting floor on joist ceilings

The floor is laid as a floating floor. Only the click connection is mechanically locked. The planks must not be spot glued, nailed, screwed or fixed by other heavy objects to the subfloor.

NOTE: In the case of heavy objects that can massively prevent the floor from floating, e.g. kitchen units and cooking islands with natural stone countertops, wood and night storage heaters, etc., we recommend either installing these before laying the floor or placing expansion joints around the objects.

In rooms where partial standing moisture can be expected, the tongue and groove joint must be additionally sealed with a joint sealant. The edge joints must be properly filled with a PE round string and then sealed with silicone.

First, measure the space. If the last row is not at least 5 cm wide, cut already the first row so that the first and last row have approximately the same width.

TIP: The patented UNICLIC® Click System offers 2 variants of installation from the second row onwards.

# INSTALLATION AND MAINTENANCE INSTRUCTIONS

## RECYCLED LEATHER SERIES

### Variant 1: „Angle to Angle“:

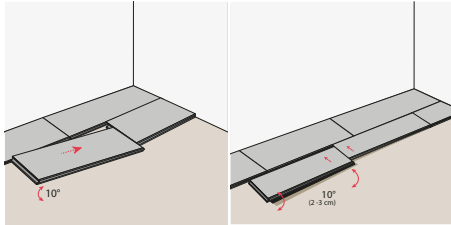

**FIRST ROW:** Start laying in a right corner of the room. Lay the first plank so that the tongue side faces the wall. Align it exactly with spacer wedges. Lever the second plank with its front tongue in exact extension into the front groove of the first plank.

After the first row has been precisely aligned using a setting lath or string, start laying the second row with the remaining piece of the last plank of the first row. The cross joints or end joints should ideally be offset by 40 cm, but at least by 20 cm.

**SECOND ROW:** The first plank of the second row is first placed at a slight angle on the long side (max. 10° / 2-3 cm) and clicked into the plank of the first row using a tapping block and hammer. Then lift the second plank and the plank next to it - already clicked in - slightly (max. 10° / 2-3 cm) and click them in lengthwise. By lightly hitting the longitudinal side of the plank and the end of the plank with a tapping block (minimum length 20 cm) and a hammer, you ensure an optimal joint closure - never use increased pressure! Lay the following planks in direct extension of the first.

### Variant 2: „Angle Snap“

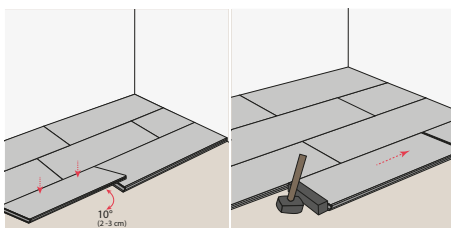

**FIRST ROW:** Start laying in a right corner of the room. Lay the first plank so that the tongue side faces the wall. Align it exactly with spacer wedges. Place the second plank just in front of the first plank and tap it together using a tapping block and hammer. Make sure that the planks are aligned.

After the first row has been precisely aligned by using a lath or string, start laying the second row with the remaining piece of the last plank of the first row. The cross joints or end joints should ideally be offset by 40 cm, but at least by 20 cm.

**SECOND ROW:** The first plank of the second row is placed at a slight angle on the longitudinal side (max. 10° / 2-3 cm) and clicked into the plank of the first row using a tapping block and hammer. On the front side, the panels are clicked into place by tapping gently with the tapping block. Always place the tapping block (at least 20 cm long) on the tongue or the lower groove cheek, not on the „good edge“. Lay the following planks in direct extension of the first.

NOTE: The spacer wedges must be removed after finishing the installation!

### Heating pipes, door stoppers

Keep a distance of at least 10 mm around the obstacle. Starting from the hole, cut out a wedge-shaped piece towards the edge. Lay the plank and replace the cut piece with adhesive tape. Any cover caps and rosettes are available in specialized stores.

NOTE: Do not screw the door stop through the floating floor onto the subfloor. This will prevent the floor from floating!

### Door frames

Place a loose plank with the top facing down against the door frame, saw it off and shorten it accordingly so that the elements can be laid floating underneath.

NOTE: Especially in this area, make sure that the planks have sufficient freedom of movement - the door frames must not stand firmly on the floor!

### Accessories

Fix the skirting profiles onto the wall and not onto the floor. Furthermore, the floor profile installation must not interfere with the floating of the floor.

### Underfloor heating

Follow the instructions of the producer/installer of the underfloor heating and the relevant regulations. After starting up the heating system, the surface temperature must not exceed 28°C.

TIP: It is recommended to use a heating protocol authorized by the screed supplier, as the recommended heating and unheating phases are explicitly mentioned there.

NOTE: Installation on a controllable electric under-floor heating system is possible under the above parameters. This must be laid to cover the room and embedded with suitable filler (min. 2 mm). In addition, the click connection must be glued at various points.

### CLEANING, CARE & PROTECTION

After installation, a final cleaning must be done. This can be done by sweeping, vacuuming or damp mopping. In case of heavy soiling, use a PU cleaner. Please follow our cleaning recommendations.

The longevity of your Karta floor depends not only on its use but also on its cleaning. Do not use aggressive and/or solvent- or glycerine-containing agents. Especially when overdosed, these can attack the surface. Be sure to follow the manufacturer's instructions on the packaging.

Only wipe with a damp cloth - never wet! In the entrance area, use dirt-trapping mats (nitrite mats) that are free of contact discoloration. Mats with rubber or latex backing, rubber caps on equipment, chair or table legs can cause discoloration of the floor. Contact points should therefore be protected if necessary.

Only use soft chair and furniture castors (type W according to EN 12529).

TIP: As initial care for these floors, a basic protection should be applied thinly and evenly. We recommend the products from the Karta accessories

NOTE: It is possible to apply a refinish to the surface immediately after installation, or even years later.

### Room climate

Karta flooring is suitable for rooms with normal climate. Therefore - also in the interest of your own health - ensure a balanced and pleasant room climate. A relative humidity of 50-60% and a room temperature of approx. 20-22 °C are ideal.

Extreme sunlight, heat and strong temperature variations can damage the material and lead to color changes or warping of the material.